

**YOUR NAME**

Start the trail at the grey arrow  
Follow the numbers from 1-13.

**1 PILLAR**

Write down the date carved into this pillar

This is when the Ch \_\_\_ was consecrated. (Ask about this word)

Join the dots to make a cross like the one on the pillar.

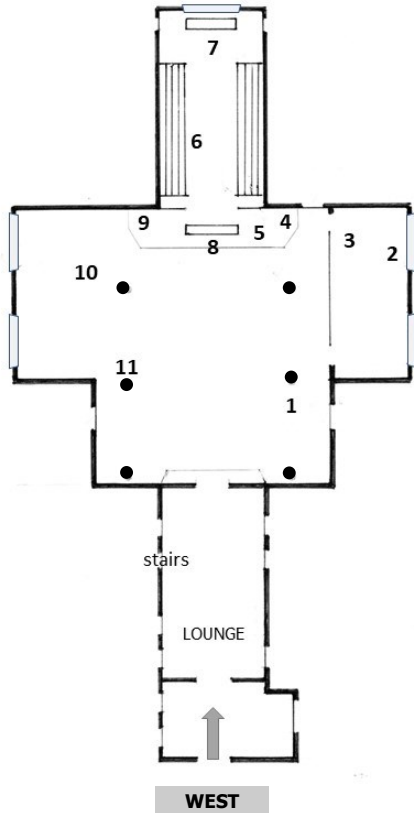
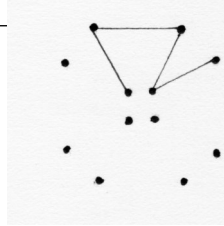

**2 CHAPEL OF THE HOLY SPIRIT**



In this window, how do we know that the man in red (Jesus) is a shepherd? \_\_\_\_\_

The font is made from w \_\_\_ and it holds w \_\_\_ for Baptism. The font has \_\_\_ sides.

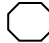
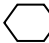
Is this an octagon  or a hexagon? 

*colour in your answer*

**3 KNEELER**

Look at the long kneeler.

Fill in the missing letters

B \_\_\_ D \_\_\_ E

There are many living things pictured in this embroidery. Find some of them in this word search.

s	q	u	i	r	r	e	l	g
h	t	r	r	a	b	b	i	t
b	e	e	p	h	o	r	s	e
g	o	o	s	e	v	o	w	l
y	f	l	o	w	e	r	s	j
c	r	a	b	q	g	o	a	t
k	f	o	x	l	g	u	l	l
b	u	t	t	e	r	f	l	y
s	h	e	e	p	f	i	s	h

**4 WAR MEMORIAL**



Why do you think this memorial is important? \_\_\_\_\_

It is made from alabaster. How does it feel?

- soft  hard  *tick your 3 choices*
- warm  cold
- smooth  rough

**5 LECTERN**

The lectern holds the

H \_\_\_ B \_\_\_

which is used for readings during services.

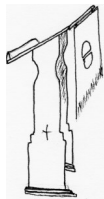

There are two lecterns in this church, this one is made from wood. The other one is made from

b \_\_\_

It is in the shape of an

e \_\_\_



**6 CHANCEL**



Above the organ pipes there are \_\_\_ angels playing

t \_\_\_\_\_

Where is the angel playing a harp?

On the floor, small marble tiles make a pattern called a

\_\_\_\_\_ (anagram of **amisco**)

Draw some of the pattern in this space

**7 ALTAR**



The Altar is the Holy Table. What colour is the cloth today?

What does the carving behind the altar show?

There are two banners, one each side of the altar. Which Churches are named?

\_\_\_\_\_ and \_\_\_\_\_

Who is pictured on the banners?

### 8 COMMUNION TABLE

During a service of Holy Communion, the Minister puts a plate (called a patten) and a cup (called a chalice) on this table.

The patten holds the

b\_\_\_\_\_ or wafers.

The chalice holds the \_\_\_\_\_

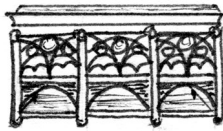

### 9 PULPIT

The pulpit is made in a type of stone called alabaster

which looks like m\_\_\_\_\_

Why is the pulpit high up?

\_\_\_\_\_

\_\_\_\_\_



### 10 MUSICAL INSTRUMENTS

Sometimes music is played on the o\_\_\_\_\_

which has windp \_ p \_ s of various sizes to make the sounds.

List 3 other musical instruments you can see

- 1.
- 2.
- 3.

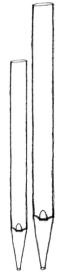

### 11 ARCHES

Sort out these jumbled words to make a sentence:  
**stone the support arches pillars the painted**

\_\_\_\_\_

\_\_\_\_\_

Are the arches **rounded** or **pointed** ?

*(draw a circle round your answer)*

What has happened to the arches at the back of the church?

\_\_\_\_\_

### 12 LOUNGE

This lounge space is used for social gatherings and meetings.  
A likeness of John Wesley is looking on.

Mark his position with a '12' on the floorplan.



Find the door marked STAIRS and go up to the Hall

### FINALLY, MATCH MATERIALS WITH OBJECTS

Match the letters (materials) with the numbers (objects). Example: A6

	material
A	embroidery
B	alabaster
C	pottery
D	sandstone
E	marble
F	metal (brass)
G	wood

	object
1	walls; pillars
2	old lectern
3	war memorial; pulpit
4	choir stalls; font
5	bust of john Wesley
6	banners; kneeler
7	chancel floor

	answer
A	6
B	
C	
D	
E	
F	
G	

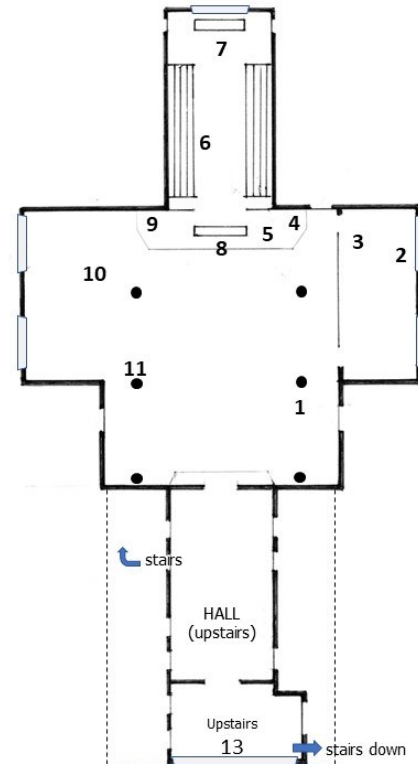

### 13 HALL (UPSTAIRS)

How do you know that this room used to be part of the church? \_\_\_\_\_

Name 4 organisations (groups) who use this room for their meetings.

\_\_\_\_\_

\_\_\_\_\_

How many faces are there in the window? \_\_\_\_\_

