

YOUR NAME :

Start the trail at the grey arrow
Follow the numbers from 1-14.

1 FONT

What goes into the font when someone (usually a baby) is made a member of the church?

W _ _ _ _

The font is two different shapes -

The top is C _ _ _ _ _ _ _ _

The middle is octagonal with _ _ _ _ _ sides?

2. TOWER

What hang in the roof space of the tower? B _ _ _ _

How many ropes are there? _ _ _ _ _

In several places on the walls of the tower find two letters linked together.

They are **Thomas Trenchard's** initials.
It is known as a monogram.



3 NAVE

There is an arcade of arches.



Are these
Rounded or
Pointed ?

Supporting the arches are huge circular 12th century pillars with carvings.

Draw the design of one of them.

EAST

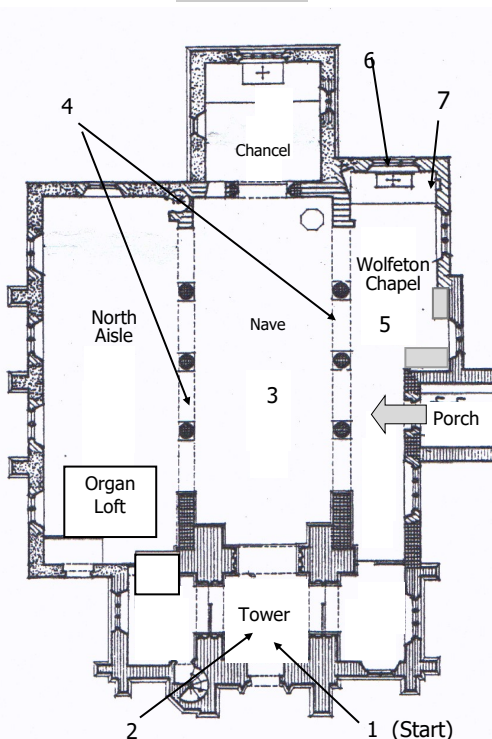

4 CLERESTORY & CORBELS

There are windows, high up in the uppermost storey, known as The Clerestory



How many styles and sizes can you see? T _ _

Supporting the wooden roof ridge are some stone carvings called corbels.

How many can you see? _ _

5 SOUTH CHAPEL

How many table tombs, now badly damaged with no names, can you see ?

Why do we call this a 'chapel' rather than an Aisle?

Because it has an A _ _ _ _

To the right of the altar, in the south wall, is a piscina. What do you think it is for?

WEST

7 GRACE POLE MEMORIAL



A very well restored monument of a lady dressed in blue.

What is she doing?

When did she die?

_- _ _

Name her husband

W _ _ _ _ P _ _ _

Her Father's name?

T _ _ _ _ T _ _ _ _

6 STAINED GLASS WINDOW



Who is the figure with a halo in the centre of the windows?

J _ _ _ _

8 PULPIT

What is this fine 17th century Pulpit made of?

W _ _ _ _



Why is it so high?

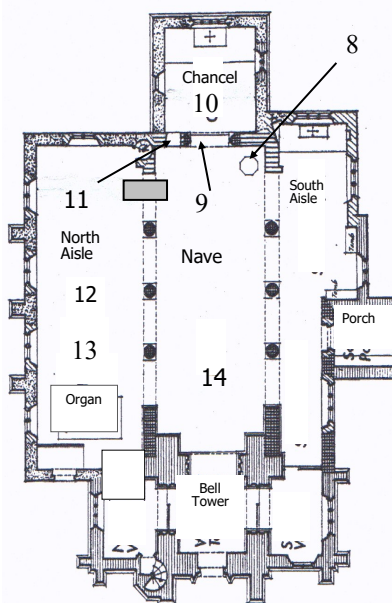

9 CHANCEL ARCH

In what way is it a different shape to the arches in the Nave?

Where else in the church have you seen this type of decoration?

To the left of the arch there is a stencilled wall painting.

What colours are the paintings?

What do you think they are?

Approximately how old do you think they are?

100 200 300 400 600 years old?

10 CHANCEL

Once you have gone up two steps and through the arch you are standing in the Chancel.

What is the main feature covered in a cloth?

A _ _ _ _

What coloured cloth is on the altar today?

Where can you see a cross or crucifix?

11 SQUINT

Standing by the altar, look through the hole (known as the squint) in this East wall.

What musical instrument can you see?

O _ _ _ _

(at least the console or keyboard part of it)

Who will have a really good view of the Priest in the chancel?

O _ _ _ _ _

12 NORTH AISLE

What happens in the North Aisle?

13 ORGAN

The organ appears to be in two places in the North Aisle.

Put an **X** where you think the sound comes from.

The organ pipes are raised above the floor. They are raised to be able to :

- A. hear it more clearly?
- B. see it better ?
- C. protect it from flooding?

Design a monogram of your initials

(See No 2 overleaf)

14 KNEELER CUSHIONS

What is the main colour of the beautifully embroidered kneeler cushions?

Why was that colour chosen for St Mary's Church Charminster?

BEFORE YOU LEAVE

Before you leave, sit quietly in a pew at the back of the church and think about your visit.

What have you liked best about the church?

We hope you have enjoyed visiting this church and will come again.